



# Quick Guide – EN

## Molift Transfer Pro

**molift**<sup>®</sup>  
by Etac

QG70101 - 2025-10-07 - Rev. 2.0

This quick guide does not replace the product's user manual. It is important to understand the contents of the user manual when operating the product. You can download the user manual at [etac.com](http://etac.com).

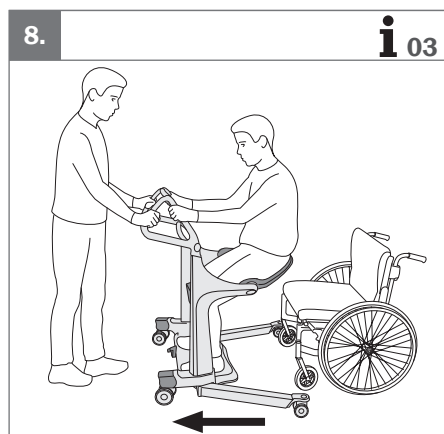
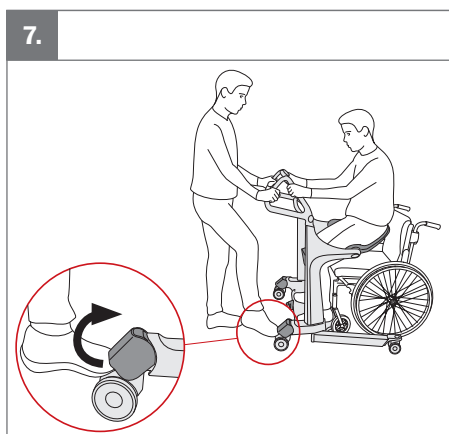
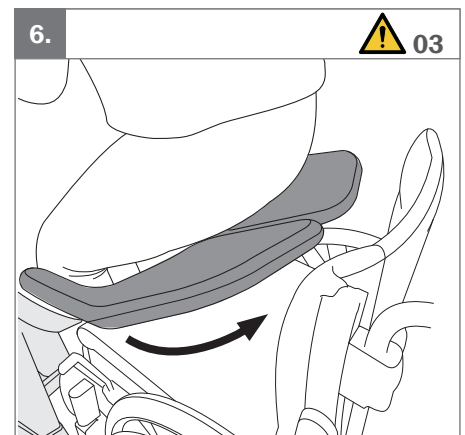
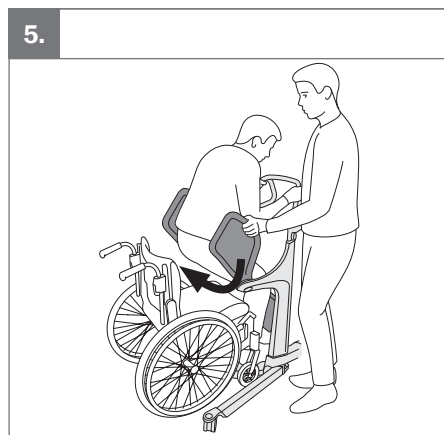
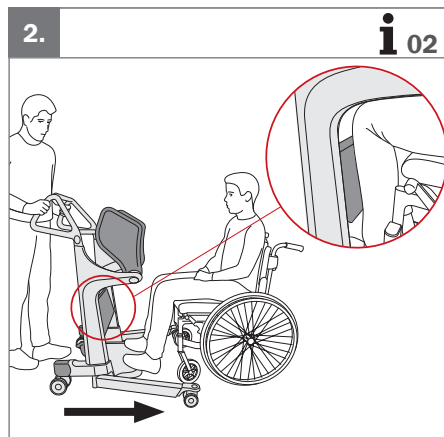
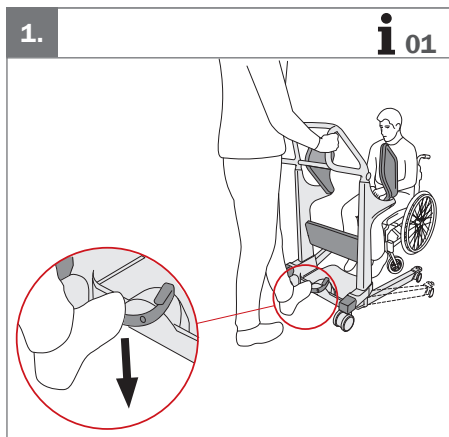

**! Warnings**

- 01. The wheels must always be locked when the user moves between sitting and standing position.
- 02. The user should always hold on to the handles during transfer.
- 03. The user must remain standing until both seat pads are rotated down.

**i Information**

- 01. Adjust the legs adjustment using the pedal. Left: wider. Right: narrower.
- 02. Place Transfer Pro so leg support reaches the user's shins.
- 03. It is optional to move the legs in during transfer.

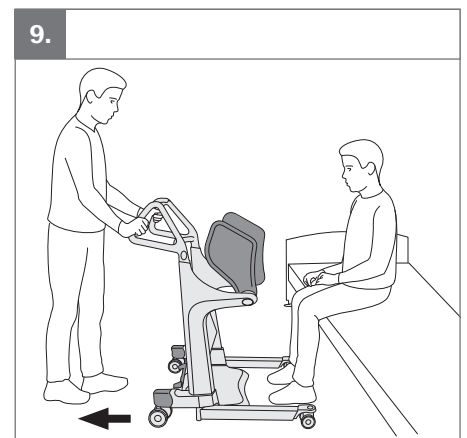
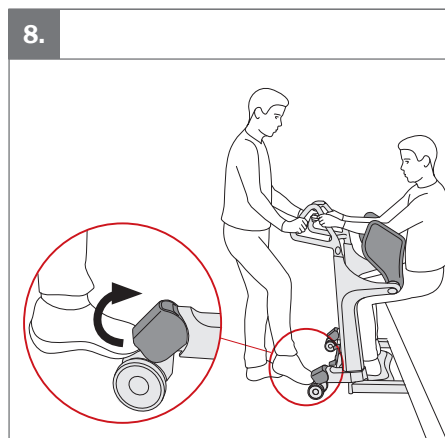
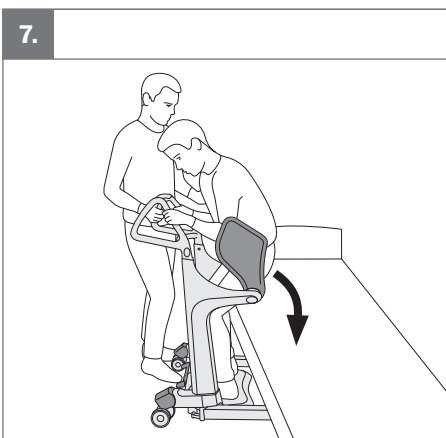
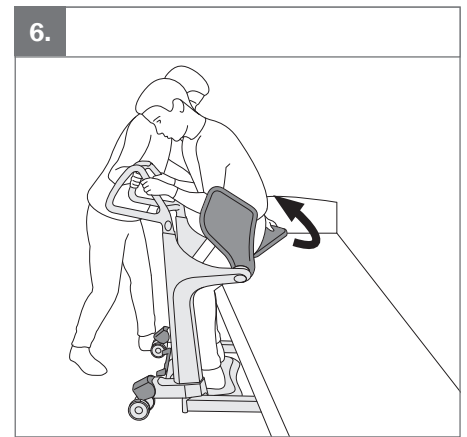
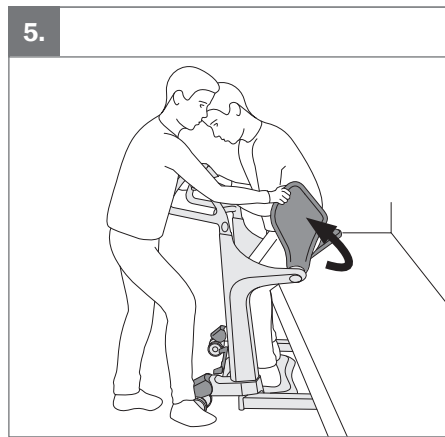
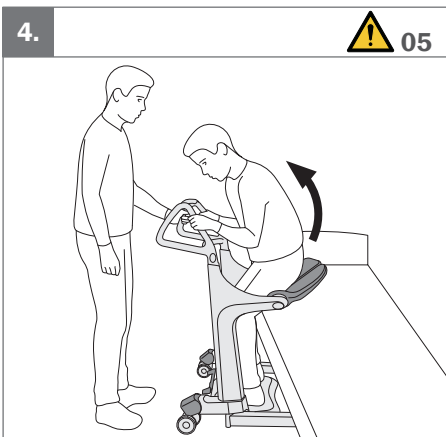
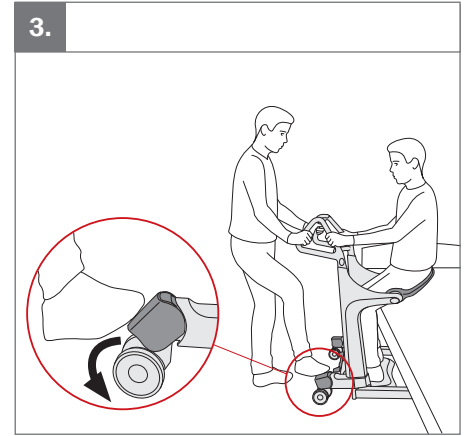
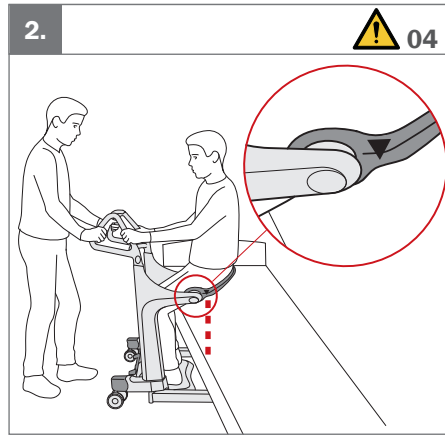
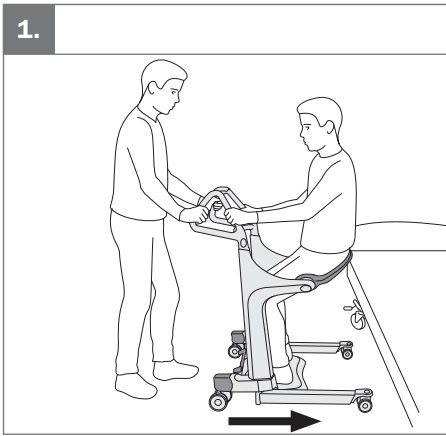

**Warnings**  
 04. Ensure that the marking on the seat pad minimum aligns with the seat's edge before the user sits down.  
 05. Always rotate both seat pads up before the user sits down.

**Technical data**

28,2kg  
62lbs

max 200 kg  
max 440 lbs

200cm  
149cm

**Cleaning**

max 70 °C  
min 10 min

min 5  
max 9

**UK REP**

**Etac Ltd.**  
 Unit 60, Hartlebury Trading Estate,  
 Hartlebury, Kidderminster,  
 Worcestershire, DY10 4JB  
 +44 121 561 2222

**CH REP**

**Promefa SA**  
 Avenue de Morges 33  
 1027 Lonay, CH  
 +41 44 872 97 79



**Etac A/S**  
 Parallevej 3  
 DK-8751 Gedved

+45 796 858 33  
 patienthandling@etac.com  
 www.etac.com

**molift**<sup>®</sup>  
 by Etac